

ECOSYS P4060dn

Monochrome Printer
for A4/A3 Format



Productivity Improvement and Cost Reduction



www.kyoceradocumentsolutions.com.my

ECOSYS P4060dn



Evolution of ECOSYS

ECOLOGY - Providing energy-saving, silent design and compact design, realize top-class environment support in the industry.

ECONOMY - Providing lower CPP and longer life-time design, enhance TCO competitiveness.

SYSTEM - Provide reliable machines by assuring compatibility with the legacy machines / improvement of stable operation / adding the function of streamlining duties

KYOCERA Document Solutions strives to be a company that contributes to the society and demonstrates a "Customer First" principle by providing customers with maximum value to increase their satisfaction. By adhering to the mission of producing document management devices that take balance between "Economy" and "Ecology", KYOCERA Document Solutions succeeds to develop document management devices with advanced technologies which help customers to optimize office productivity and efficiency at a low total cost of ownership and, at the same time, improving environmental performance.

Options

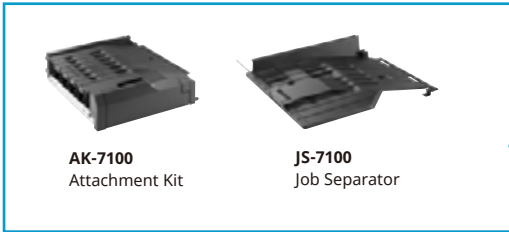

Excellent Overall Performance

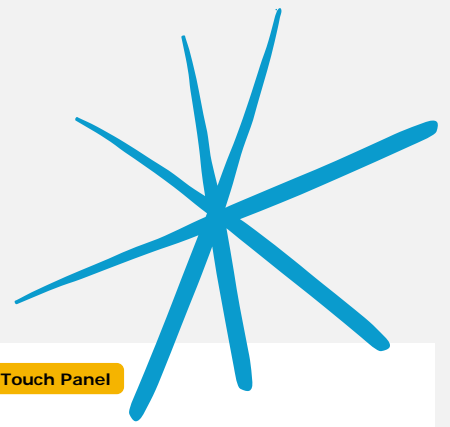

Operation Panel (9 inch panel, Ten-keys)

It makes panel operation very easy and visual.



Support 1200dpi Print Resolution

Supporting 1200dpi (4800dpi x 1200dpi) enables considerably higher image quality print than previous models.

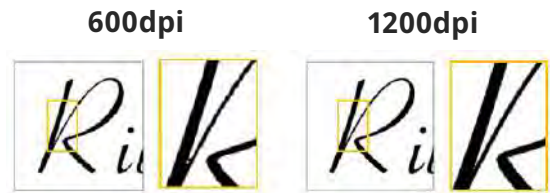

To mount the self-closing mechanism into the paper feeder.

Papers can be set accurately and quietly with a little physical strength.

Half auto drawing in cassette

- Insert the cassette manually to rear
- Auto drawing in at last 40mm



Banner Print

Produce banner with various paper weight in-house anytime in need (One-sided only).



Convenient Multi-Purpose Tray First Mode

Allow printing via Multi-Purpose Tray whenever paper is loaded there.



NFC Support

- Support optional Wireless LAN to expand the connect ability.
- Just put over NFC then it will connect via Wi-Fi Direct.

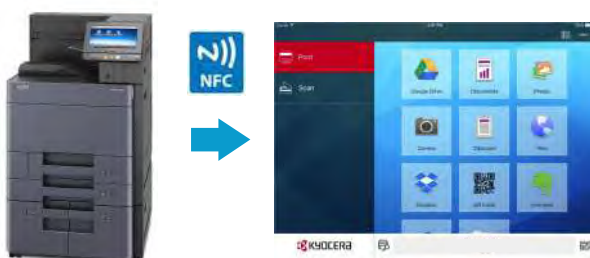

Using cylindrical toner container Realizing compact design.

The empty BK toner container can be reused as a waste toner bottle.

Cylindrical toner container





Streamlining Daily Business Process

By combining the innovative Business Application, this printer can manage document in an effective approach.

Take advantage of KYOCERA Net Manager, a server-based web application, to efficiently provide secure printing and copying and enable easy accounting of print-related expenses. The Print&Follow function allows users to securely print to any printer managed by KYOCERA Net Manager.

Kyocera Business Apps are powered by HyPAS™ (Hybrid Platform for Advanced Solutions), a Kyocera-developed software platform that expands your MFP and Printer's core capabilities with simple touch-screen operations that address your unique workflow needs. From mobile and cloud to cost control and security solutions, these business applications seamlessly and securely integrate with Kyocera MFPs and Printers.

Eco-friendly advantages

The ECOSYS P4060dn helps your business maintain a tidy environmental footprint by reducing waste and eliminating unnecessary consumption.

- Exclusive long-life technology and consumables.
- Sharply reducing TEC value.
- Supporting EPEAT (Gold).
 - Using recycled materials for exterior cover and cassettes
- ENERGY STAR® compliant, with Low Power Mode and Sleep Mode settings. (Available in Taiwan only)
- Environmentally-friendly Waste Toner Bottle design.



Main Specifications		
Model	ECOSYS P4060dn	
Type	Desktop	
Writing Method	Semiconductor Laser	
Print Speed (A4)	60 ppm	
First Print Out Time	3.8 seconds	
Warm Up Time	17 seconds	
Resolution	1,200 x 1,200 dpi, 4,800 x 1,200 dpi level	
Duplex	Auto	
Control Panel	9 inch Color Touch LCD Panel	
Power Consumption (Standard configuration)	Print Mode	820W
	Stand-by Mode	40W
	Sleep Mode	1W
Noise (ISO7779/ ISO9296)	Print Mode	35dB(A)
	Stand-by Mode	69dB(A)
Dimension (W x D x H) (Main Unit)	602mm x 665mm x 790mm	
Weight (Main Unit)	Approx. 77.2 kg	
Controller		
CPU	T1024 (Dual Core) 1.2 GHz	
Memory	Standard 4GB (Max. 4GB)	
SSD/HDD Capacity	SSD 8GB (Standard) / HDD 320GB (Standard)	
Interface	USB 2.0 High Speed x1; Ethernet 10BASE-T/100BASE-TX/1000BASE-T; USB Host x4; NFC TAGx1; e-KUIO x2; 802.11 b/g/n/Wireless LAN/WiFi Direct (optional)	
PDL	PCL6 (PCL5e, PCL-XL), KPDL3 (Postscript 3 compatible), PRESCRIBE, PDF Direct Print Ver. 1.7, XPS, Open XPS	
Network Printing	TCP/IP, FTP, LPR, Port9100, IPP, IPP over SSL, NetBEUI, WSD Print, Apple Bonjour, IPsec, SNMPv3, IEEE802.1x, IPP over SSL/TLS, HTTP over SSL/TLS, FTP over SSL/TLS, SMTP over SSL/TLS, POP3 over SSL/TLS, Enhanced WSD over SSL/TLS	
Operating System Supported	Windows Server 2008/2008 R2/2012 R2; Windows Vista/7/8/8.1/10; Apple Macintosh OS X 10.5 or later; Linux	
USB Memory Printing	Standard	
USB Memory Printing Format	TIFF, JPEG, PDF, XPS, OpenXPS	
Mobile Printing	AirPrint, Mopria, KYOCERA Mobile Print	
Paper Handling		
Paper Capacity	Standard	2 x 500 sheets (Cassette) + 150 sheets (MPT)
	Maximum	7,150 sheets (Main Unit + 2 x1,500 sheets PF-7110 x1 + 3,000 sheets PF-7120 x1 + MPT)
Paper Size	Cassette	Max. SRA3 (320mm x 450mm) - Min. A6R; Cassette 1 Max. A4R (Legal) - Min. A6R
	Option	Max. SRA3 (320mm x 450mm) - Min. A6R
	MPT	Max. SRA3 (320mm x 450mm) - Min. A6R & Banner Print of 1,220mm
Paper Weight	Cassette	52 - 300 g/m ²
	Option	52 - 300 g/m ²
	MPT	52 - 300 g/m ²
Duplex Printing	Paper size: Max. SRA3 (320mm x 450mm) - Min. A6R; Paper weight: 52 - 256 g/m ²	
Output Capacity	Max. 500 sheets + 100 sheets face-down with Job Separator	
Consumables & Options		
Toner Kit (Page Yield in accordance with ISO/IEC 19752)	TK-6335 : 32,000 pages	
Capacity of Start Up Toner	16,000 pages	
Maintenance Kit	MK-6335 : 600,000 pages	
Waste toner bottle	WT-8500 : 70,000 pages	
Paper Feeder	PF-7100: 500 sheets x 2; PF-7110: 1,500 sheets x 2 (A4/Letter); PF-7120: 3,000 sheets Large capacity side deck (A4/Letter)	
Finisher	AK-7100: Attachment Kit; DF-7120: 1,000 sheets Finisher; DF-7110: 4,000 sheets Finisher; PH-7C: Punch Unit for DF-7110/ DF-7120; MT-730(B): 7 Bin Mailbox; JS-7100: Job Separator; BF-730: Booklet Folder; SH-10: Staple for DF-7120/BF-730; SH-12: Staple for DF-7110	
Card Authentication	Card Authentication Kit(B)	
Data Security	Data Security Kit(E)	
Gigabit Ethernet Board	IB-50: For additional Network	
Wireless LAN Interface	IB-35: 802.11 b/g/n/Wireless LAN/WiFi Direct	
Banner Guide	Banner Guide 10	
Numeric Key Pad	NK-7100(B)	

KYOCERA Document Solutions Malaysia Sdn. Bhd.

No.71, Ground Floor, Jalan SS 15/5A, 47500 Subang Jaya,
Selangor Darul Ehsan, Malaysia
Tel: +603-56345609 Fax: +603-56125531
Customer careline: 1700-816-100



www.kyoceradocumentsolutions.com.my

Kyocera Document Solutions does not warrant that any specifications mentioned will be error-free. Specifications are subject to change without notice. Information is correct at time of going to press. All other brand and product names may be registered trademarks or trademarks of their respective holders and are hereby acknowledged.