

Avision

A vision of your office

Avision AM7640i/ AM7630i/AM5630i

Make Document Flow Easy



Avision

A vision of your office

Intelligence copy functions with Avision technology



Unique auto crop / deskew and blank page removal feature

The Avison's innovative intelligent copy allows you to insert your document to the feeder or on the glass platen without alignment, and then the next second a perfect copy can be done automatically.



Make copy as easy as Drop N Take

The intelligent "Drop N Take" feature allows you to simply load your document easily to the feeder or on the glass and then the next second your copy is automatically straightened. It is simply that easy !



Advanced scanning capabilities

The product lets you scan paper-based documents in full color in PDF, JPEG, or TIFF file format and send them to a variety of destinations such as E-mail, FTP, USB and network folder (SMB).

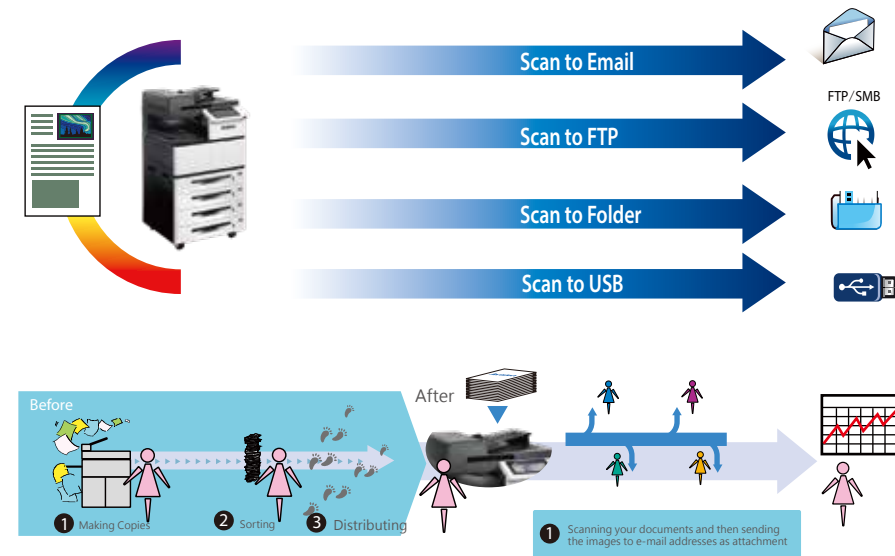

Easy-to-use via the simple user interface

Easy to use and navigate the large 8-inch bright color touch screen and user interface.

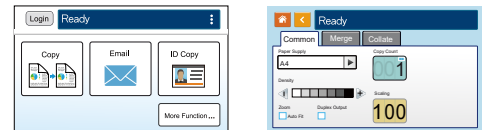

Convenient mobile printing, and scanning



Wirelessly print, or scan from your mobile devices through Avision's app for the MFPs.

Two reading heads, save twice working time

2-SIDED

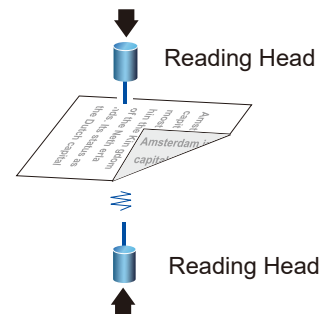
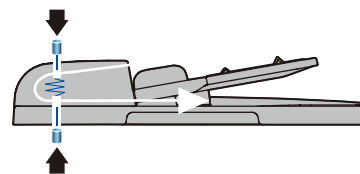

Easy Customization Based on a Popular Tablet System

Based on a popular tablet operating system, the Avision MFP provide convenience to customize your workflow so that your work is easy to be done.



Avision A3 MFP AM5630i/AM7630i/ AM7640i

General Specifications

| Model | AM5630i | AM7630i | AM7640i |
|----------------------------------|---|--------------------|--------------------|
| Functions | Copier - Printer - Scanner - Fax - Network | | |
| CPU | 1GHz (Dual Core) | | |
| RAM | 2G | | |
| HDD | 500G~1TB | | |
| Display | 8" LCD | | |
| Manual tray | | | |
| Paper capacity | 100 sheets (70 g/m ² plain paper) | | |
| | A3, A4, B4(JIS), A5, B5(JIS), A6, B6(JIS), letter, legal, customized size | | |
| | 106 x 148 to 304.8 x 431.8 mm | | |
| Paper weight | 60 to 163 g/m ² | | |
| Tray1 and tray2 | | | |
| Paper capacity | 500 sheets (70 g/m ² plain paper) | | |
| | A3, A4, B4(JIS), A5, B5(JIS), letter, legal, customized size | | |
| | 148 x 210 to 304.8 x 431.8 mm | | |
| Paper weight | 60 to 105 g/m ² (Optional) | | |
| Tray 3 and tray 4 | | | |
| Paper capacity | 500 sheets (70 g/m ² plain paper) | | |
| | A3, A4, B4(JIS), A5, B5(JIS), letter, legal, customized size | | |
| | 148 x 210 to 304.8 x 431.8 mm | | |
| Paper weight | 60 to 105 g/m ² | | |
| *Standard support paper capacity | 600 sheets | 1,100 sheets | 1,100 sheets |
| *Maximum support paper capacity | 2,100 sheets | | |
| Paper output | Top output | | |
| Paper output capacity | 500 sheets | | |
| Duplex printing unit | Built-in | | |
| Duplex print | | | |
| Paper size | A3, A4, B4(JIS), A5, B5(JIS), letter, legal, customized size | | |
| | 148 x 210 to 304.8 x 431.8 mm | | |
| | 60 to 105 g/m ² | | |
| Connectivity | USB2.0, RJ-11, RJ-45 | | |
| Power Source | 100-120 VAC, 60 Hz or 220-240 VAC, 50/60 Hz | | |
| Dimension (Wx Dx H) mm | 575 x 568 x 585 | 575 x 568 x 786 | 575 x 568 x 786 |
| Dimension (Wx Dx H) in. | 22.6 x 22.3 x 23 | 22.6 x 22.3 x 30.9 | 22.6 x 22.3 x 30.9 |
| Weight | 37 kg (81 lb.) | 45 kg (99 lb.) | 45 kg (99 lb.) |
| Features | Dual head scanning duplex ADF (only for AM7630i, AM7640i), Auto paper size detection, Auto Rotate, Print from USB, Network Scan, Multi-language User Interface Support, USB Host, Copy, Fax Backup, Web Utility, Account Authority Management | | |

* AM5630i Standard support paper capacity: 100 sheets manual tray + 500 sheets tray1

* AM7630i/ AM7640i Standard support paper capacity: 100 sheets manual tray + 500 sheets tray1 + 500 sheets tray2

* AM5630i / AM7630i/ AM7640i Maximum support paper capacity: 100 sheets manual tray + 500 sheets tray1 + 500 sheets tray2 + 500 sheets tray3 + 500 sheets tray4

Print Function

| Model | AM5630i | AM7630i | AM7640i |
|-----------------------------|--|--------------------|--------------------|
| Printing Method | LSU | | |
| Printing Speed | 30 ppm (A4 LEF) | 30 ppm (A4 LEF) | 40 ppm (A4 LEF) |
| First print out time (FPOT) | < 9sec. | | |
| Max media size | 297 x 420 mm | | |
| Min media size | 100 x 148 mm | | |
| Resolution | 1200 x 1200 dpi | | |
| PDLs/ Emulations | PCL / PS / GDI | | |
| N-up Print | 2 to 16 in one | | |
| Scaling | 25 ~ 400%, Fit to Paper | | |
| Edge Erase | 4.3 mm (top, bottom, left, right) | | |
| Duplex Print | Booklet, Calendar | | |
| Print Feature | Auto Paper Tray Select, Collate, Watermark, Print from USB, Direct Print (USB storage), Network Print | | |

Copy Function

| Model | AM5630i | AM7630i | AM7640i |
|-----------------------------------|---|--------------------|--------------------|
| Copy Size | Ledger (ADF only), A3, Legal, Letter, A4, A5, B4(JIS), B5(JIS), 8K, 16K, Postcard | | |
| Max. scanning size | A3 (Ledger at ADF) | | |
| Min. media size | 100 x 148 mm | | |
| Copy Resolution | 600 x 600 dpi | | |
| Copy Speed | - | 30 cpm (A4 LEF) | 40 cpm (A4 LEF) |
| Copy Count | 999, Auto Reset to 1 | | |
| intelligent copy | auto crop / autodeskew / auto blank page removal | | |
| Flatbed auto paper size detection | LTR, A4, LGL, A3 | | |
| ADF auto paper size detection | DLT, A3, LG, B4(JIS), A4 SEF, A4 LEF, A5SEF, A5LEF, B5(JIS) SEF, B5(JIS) LEF, LT LEF | | |
| Auto Paper Tray Select | Yes | | |
| Zoom | 25 ~ 400% | | |
| Full Page Copy | Yes | | |
| N-up Copy | 2 in 1, 4 in 1, ID card | | |
| Duplex Copy | Booklet, Calendar | | |
| Copy Sides | 1->1, 2->1, 1->2, 2->2 | | |
| Density | Level 1~7 | | |
| Features | Collate Rotate Collate, Watermark, Toner Save mode | | |

Scan Function

| Model | AM5630i | AM7630i | AM7640i |
|----------------------------------|--|---------------|---------------|
| Technology | Contact Image Sensor (CIS) | | |
| Light Source | R/G/B LED | | |
| Document feeding mode | Flatbed | ADF + Flatbed | ADF + Flatbed |
| Optical resolution | 600 x 600 dpi | | |
| intelligent scan | auto crop / autodeskew / auto blank page removal | | |
| Scan speed(ADF) (A4 @300 dpi) | - | 60 ppm/120ipm | 60 ppm/120ipm |
| Grayscale mode | 16 bit input, 8 bit output | | |
| Color mode | 48 bit input, 24 bit output | | |
| File format | | | |
| Color | JPEG, PDF-M, TIFF | | |
| | Gray | | |
| | B/W | | |
| Features | Network Scan, Scan to USB, Scan to FTP, Scan to E-mail | | |
| ADF Min. Scan Size | 148 x 210 mm (5.8 x 8.3 in.) | | |
| ADF Max. Scan Size | Ledger | | |
| Flatbed Max. Scan Size | 297 x 420 mm (11.7x 16.5 in.) | | |
| ADF Capacity | - | 100 sheets | 100 sheets |
| Paper Thickness and Weight | 60 ~ 105 g/m ² (16 ~ 28 lb.) | | |

Fax Function (optional)

| | |
|-------------------|---|
| Transmission rate | Up to 33.6 kbps |
| Fax in Queue | Up to 8MB |
| Color Fax Support | Yes (JPEG) |
| Speed Dial | 200 Locations |
| Fax Broadcast | Yes (100) |
| Resolution | Up to 200 x 400 dpi |
| Fax Features | Delay Fax, Memory Fax, Security Fax, PC Fax |

Software/ Consumables

| | |
|-------------------------|--|
| Software | |
| Software Driver Support | Win11/ Win10/ Win8.X/ Win7/ Mac |
| Consumables | |
| Toner Cartridge | 6,000 prints/ 10,000prints/ 20,000prints |
| Drum unit | 150,000 prints |
| Development unit | 300,000 prints |
| Fusing Unit | 300,000 prints |

* Specifications subject to change without notice.

All brand names, product names, and trademarks mentioned in this document belong to their respective holders.